

# SLIDING DOOR SYSTEM\_ S34 BI-FOLD

## PRODUCT LIST

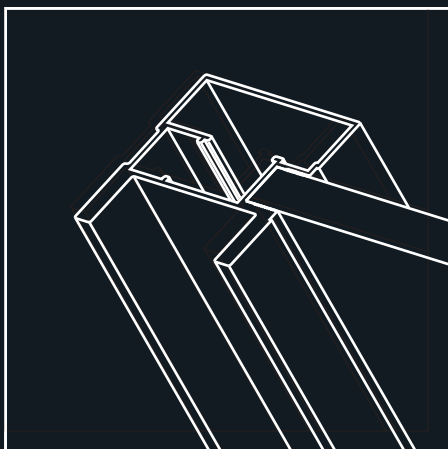

System description

Accessories

**raumplus**

## **SLIDING DOOR SYSTEM\_ S34**

1.0\_ System description\_ page 03

2.0\_ Profiles\_ page 04

3.0\_ Profile finishes\_ page 05

4.0\_ Panels\_ page 06 - 09

5.0\_ Top track\_ page 10

6.0\_ Accessories\_ page 11 - 12

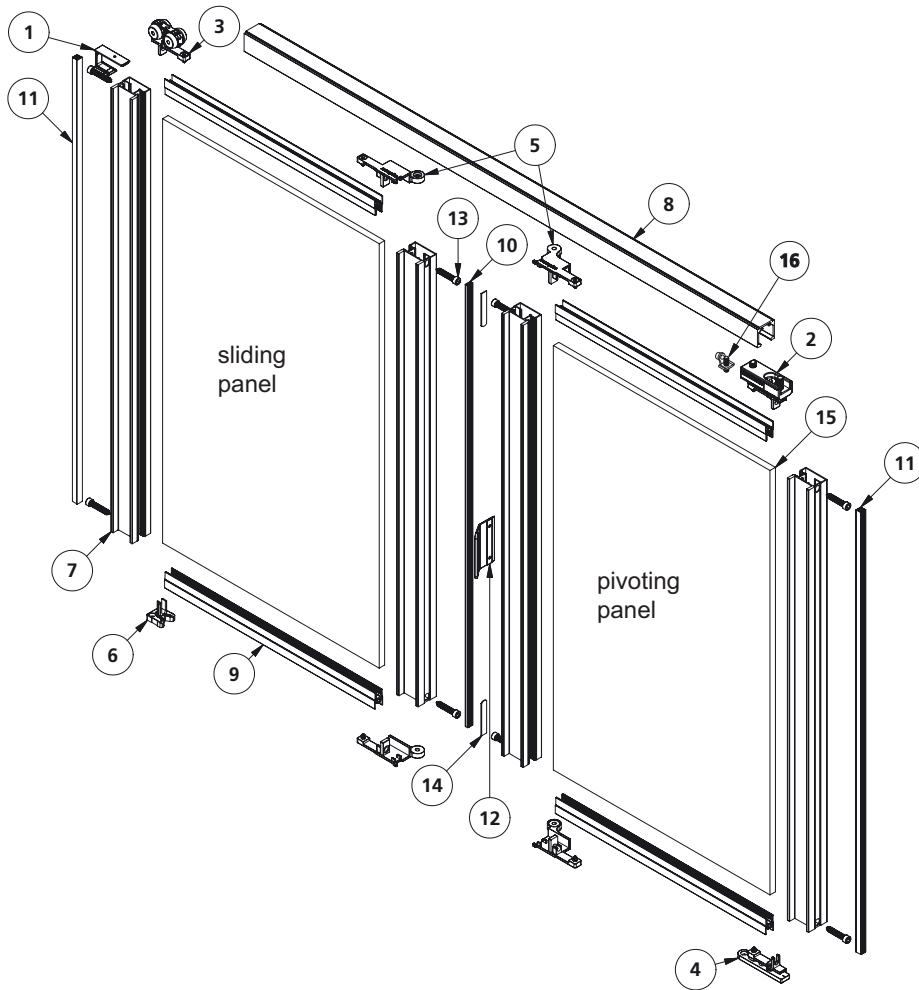

Each folding door is composed of the following:

**Top track**

8\_ Folding door top track

**Door**

- 1\_ Positioning for folding door (1)
- 2\_ Upper Bi-fold hinge (1)
- 3\_ Top roller + pick-up element (1)
- 4\_ Lower Bi-fold hinge + mounting plate (1)
- 5\_ Center hinge, top and bottom (1)
- 6\_ Pin with catch
- 7\_ S300 Asymmetrical stile (4)
- 9\_ Top and bottom rail, folding door (4)
- 10\_ Brush gasket (2)
- 11\_ Brush gasket, special version (1)
- 12\_ Bi-fold handle (1)
- 13\_ Frame screw (8)
- 14\_ Plug for punched hole (4)
- 15\_ Panel (2), not included with frame kit
- 16\_ Stopper for top track (1)

### 1.1\_ Overview

The key features of our made-to-measure system are versatility in customization and quality of our hardware allowing for individual solutions and unparalleled operation. The compact depth of the S34 system creates an ideal solution for closet doors in residential applications.

Doors can be ordered fully assembled with our standard panel materials or as frame kits to accommodate a panel material of your choosing. Assembly of doors with customer's own materials (COM) is available; please contact Raumplus for more information. Door panels ship unattached for ease of installation.

### 1.2\_ Fully assembled

Made-to-measure per specifications with the following design parameters:

- \_ Maximum height 2750 mm [9'- 0"]
- \_ Maximum width 1500 mm [5'- 0"]
- \_ Maximum weight 60kg [130lbs]

### 1.3\_ Frame kit

Frame kits are made-to-measure per specifications and ready for assembly using customer's own panel material. In addition to the design parameters listed for fully assembled doors, please consider the following:

- \_ Minimum panel thickness 4mm [5/32"]
- \_ Maximum glass thickness 8mm [5/16"]
- \_ Maximum solid panel thickness 10mm [3/8"]

Appropriate panel gasket to be specified when ordering:

- \_ 4mm [5/32"]
- \_ 5mm [3/16"]
- \_ 6mm [1/4"]
- \_ 7mm [9/32"]
- \_ 8mm [5/16"]

\*Gasket not required for solid 10mm [3/8"] material

# SYSTEM DESCRIPTION\_ S34 BI-FOLD

## FOLDING DOOR SYSTEM

### 2\_ Profiles

#### 2.1\_ S300 Isometric view

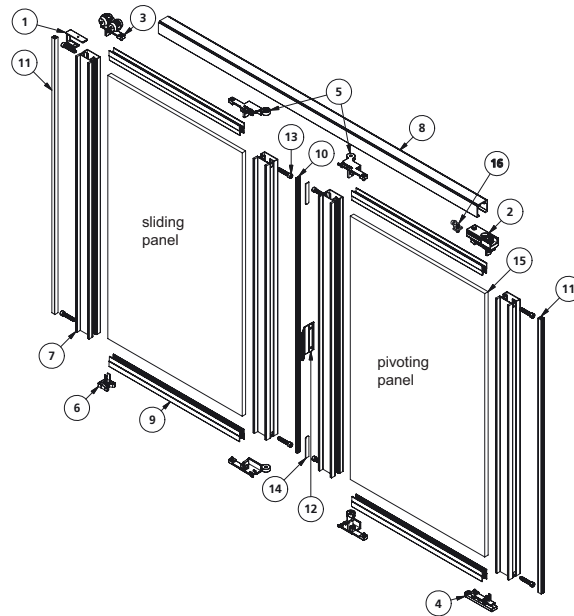
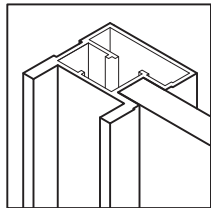

Each folding door is composed of the following:

#### Top Track

8\_ Folding door Top track

#### Door

- 1\_ Positioning for folding door (1)
- 2\_ Upper Bi-fold hinge (1)
- 3\_ Top roller + pick-up element (1)
- 4\_ Lower Bi-fold hinge + mounting plate (1)
- 5\_ Center hinge, top and bottom (1)
- 6\_ Pin with catch (1)
- 7\_ S300 Asymmetrical stile (4)
- 9\_ Top and bottom rail folding door (4)
- 10\_ Brush gasket (2)
- 11\_ Brush gasket, special version (1)
- 12\_ Bi-fold handle (1)
- 13\_ Frame screw (8)
- 14\_ Plug for punched hole (4)
- 15\_ Panel (2), not included with frame kit
- 16\_ Stopper for top track (1)

#### S300 Section and stile detail

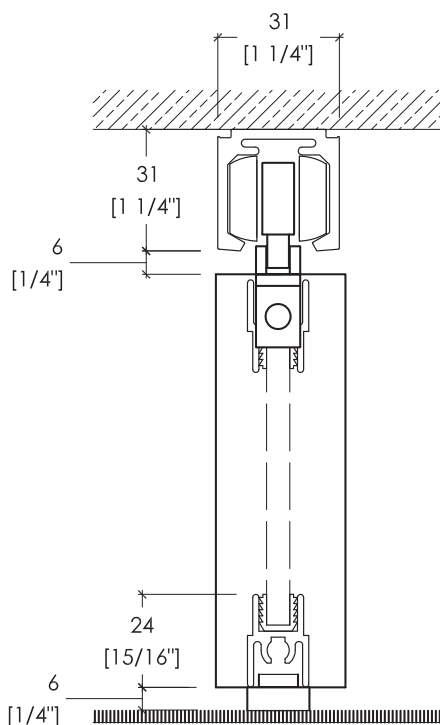

#### Asymmetrical

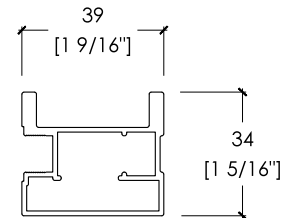

#### S300 Stile

#### Finish

Standard: Clear anodized aluminum (silver)

#### Application

Residential projects  
Closet doors

#### Dimensions

Max size 1500mm x 2750mm [5' x 9'] (Two panels)  
Max weight 60kg [130lbs]  
Panel thickness 4mm [3/16"] to 10mm [3/8"]

**3\_ Profile finishes**

**3.1\_ Standard finish \_ Clear anodized aluminum (silver)**

A factory applied finish, anodizing increases wear resistance and gives the surface a smooth matte aluminum appearance. Color for representation purposes only.

				
<p><b>Standard finish</b>  <b>Clear anodized (silver)</b></p>				

# SYSTEM DESCRIPTION\_ S34 BI-FOLD

## FOLDING DOOR SYSTEM

### 4\_ Panels

#### 4.1\_ MDF

Medium density fiberboard (MDF) is an engineered wood product made of wood fibers, wax and resin. MDF is an ideal surface for painting, application of direct glue wall-covering, or a base for upholstered panels. Maximum size 1219mm x 2438mm [4'-0" x 8'-0"]. Colors for representation purposes only.



**MDF**  
**6mm [1/4"]**

#### 4.2\_ Decor

Melamine Décor is a thin single melamine paper bonded to particle board; this is also referred to as direct pressure laminate. Maximum size 1219mm x 2438mm [4'-0" x 8'-0"]. Single-sided only. Colors for representation purposes only.

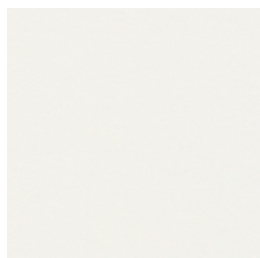

**White**  
**6mm [1/4"]**

#### 4.3\_ Magnetic marker board

Double-sided magnetic marker board is a white dry erase board. Maximum size 914mm x 2134 [3'-0" x 7'-0"]. Colors for representation purposes only.



**6mm [1/4"]**

**4.4\_ Plastic laminate**

Plastic laminate is made from layers of resin-impregnated paper topped with a decorative melamine surface, and then pressed into sheets under extreme pressure and heat. Panels when mounted to a MDF core are approximately 3/8" thick. Manufacturers include, but are not limited to: Abet Laminati, Formica, Lamin-Art, Nevamar, Pionite and Wilsonart. Maximum size 1219mm x 2438mm (4'-0" x 8'-0") Available single- and double-sided. Colors for representation purposes only.

**8mm [5/16"]****4.5\_ Chalk board**

Single-sided black chalk board. Maximum size 1219mm x 2438mm [4'-0" x 8'-0"]. Single-sided only. Colors for representation purposes only.

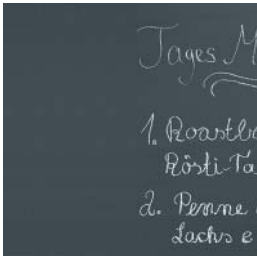
**6mm [1/4"]**

# SYSTEM DESCRIPTION\_ S34 BI-FOLD

## FOLDING DOOR SYSTEM

### 4.6\_ Veneer

Vertical grain wood veneer panels are available single or double-sided and comprised of engineered wood. Maximum size 1219mm x 2438mm [4'-0" x 8'-0"]. Colors for representation purposes only. All panels have a satin clear-coat finish.

				
<b>Quarter cut maple</b> VE-QM-001 8mm [5/16"]	<b>Quarter cut golden teak</b> VE-QGT-001 8mm [5/16"]	<b>Quarter cut zebrano</b> VE-Q2-001 8mm [5/16"]	<b>Quarter cut white oak</b> VE-QW0-001 8mm [5/16"]	<b>Flat cut cherry</b> VE-FC-001 8mm [5/16"]
				
<b>Quarter cut wenge</b> VE-QW-001 8mm [5/16"]	<b>Quarter cut teak</b> VE-QT-001 8mm [5/16"]	<b>Ribbon sapele</b> VE-RS-001 8mm [5/16"]	<b>Quarter cut dark walnut</b> VE-QDW-001 8mm [5/16"]	





**4.7\_ Laminated glass**

Laminated glass, often referred to as "safety glass", is strong and durable and designed to maintain its integrity in the event of breakage. Maximum size 1524mm x 2743mm [5'-0" x 9'-0"]. Colors for representational purposes only.

				
<b>Clear</b> 6mm [1/4"]	<b>Cool white</b> 6mm [1/4"]	<b>Diffused white</b> 6mm [1/4"]	<b>Polar white</b> 6mm [1/4"]	<b>Grey</b> 6mm [1/4"]

**4.8\_ Tempered glass**

Tempered glass is manufactured to exact size and is stronger than regular glass. If broken the glass shatters into small fragments instead of sharp shards. Maximum size 1524mm x 2438mm [5'-0" x 8'-0"]. Colors for representation purposes only.

				
<b>Clear</b> 6mm [1/4"]	<b>Satin etched</b> 6mm [1/4"]			

**4.9\_ Mirrored glass**

Silver mirror backed with a safety film. Single-sided mirror only, best used for closets. Maximum size 1219mm x 2743mm [4'-0" x 9'-0"]. Colors for representation purposes only.

				
<b>Mirror</b> 4mm [5/32"]				

# SYSTEM DESCRIPTION\_ S34 BI-FOLD

## FOLDING DOOR SYSTEM

### 5\_ Top track

#### 5.1\_ S34 Bi-fold top track

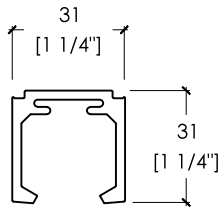
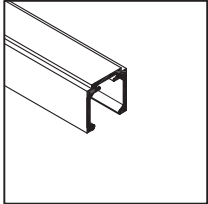

**15.45.020**

**S34 Bi-Fold top track**

**Finish**  
Standard

**Description**  
Ceiling- mounted (only)  
Max length 4877mm [16'-0"]  
No end caps available

**6\_ Accessories**

**6.1\_ True divider**

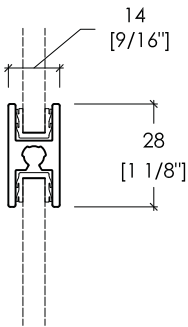
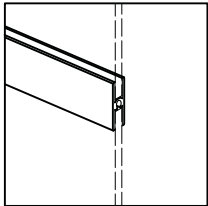

<b>13.22.020</b>
<b>True dividing rail</b>
<b>Finish</b> Standard
<b>Description</b> Use to partition different materials horizontally or *vertically within a door *Consult raumplus for vertical partitioning, cannot combine horizontal and vertical true dividers within one door Note: Frame kits not drilled for dividers

**6.2\_ Single-sided applied dividing rail**

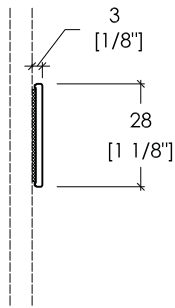
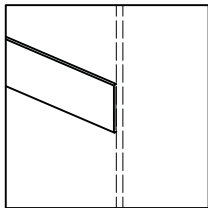

<b>13.33.020</b>
<b>Single-sided applied dividing rail</b>
<b>Finish</b> Standard
<b>Description</b> Provided with adhesive backing Applied divider can be used horizontally or vertically

**6.3\_ Double-sided applied dividing rail**

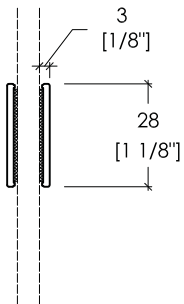
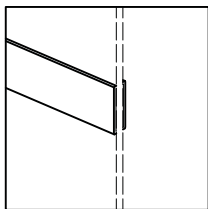

<b>13.33.020</b>
<b>Double-sided applied dividing rail</b>
<b>Finish</b> Standard
<b>Description</b> Provided with adhesive backing Applied divider can be used horizontally or vertically

# SYSTEM DESCRIPTION\_ S34 BI-FOLD

## FOLDING DOOR SYSTEM

### 6.4\_ S34 Bi-fold center handle

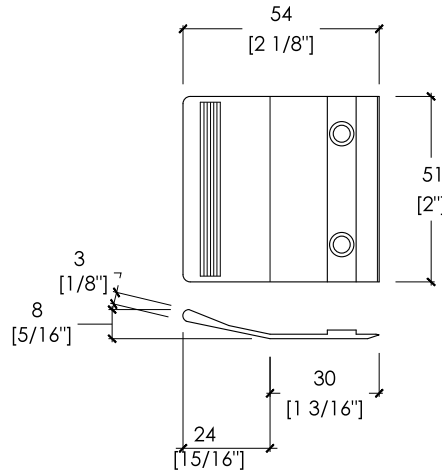
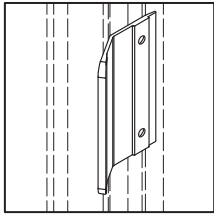

10.01.807

**Center handle**

**Finish**  
Standard

**Description**  
Used to pull door open.  
Standard, included with bi-fold

### 6.5\_ Rod handle

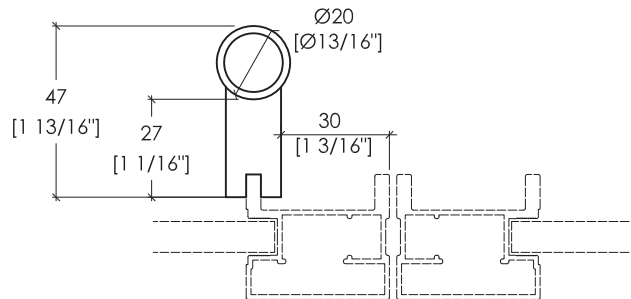
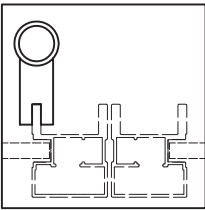

ACC-RDH-300

**Rod handle for S300 bi-fold**

**Finish**  
Standard

**Description**  
Adds vertical rod handle to S300 Bi-fold.  
One or two per door, optional  
\*Includes plastic silver end caps  
\*Available in 305mm [1'-0"] increments

### 6.6\_ Catch

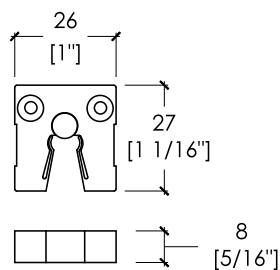
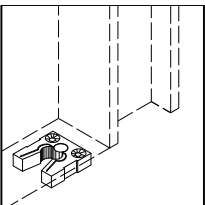

10.02.255

**Pin and Catch**

**Finish**  
Grey plastic

**Description**  
Holds bottom of door in the closed position  
Pin is exposed when door is in the open position. Pin sits 17mm [11/16"] from opening on the floor.

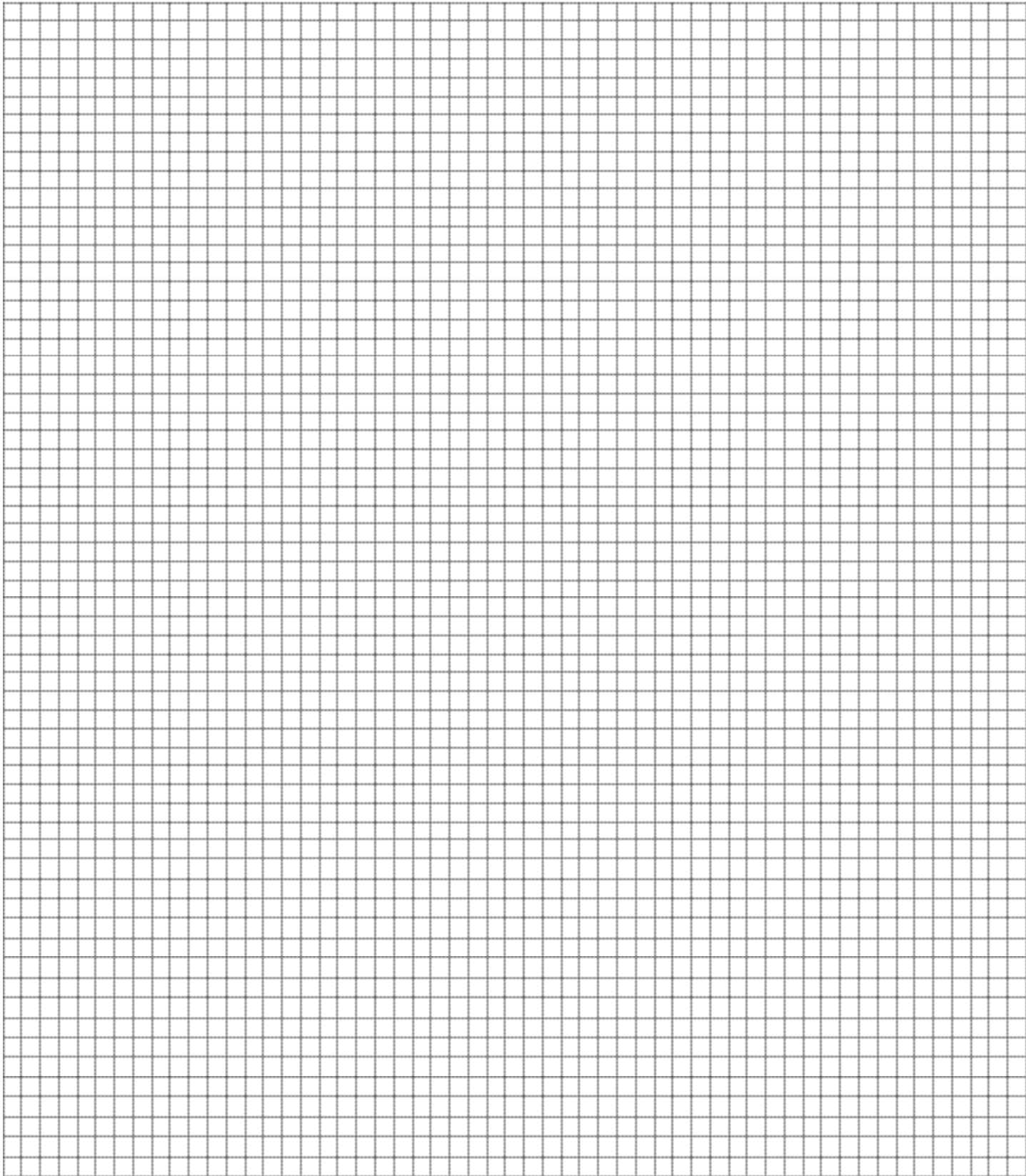

# SYSTEM DESCRIPTION\_ S34 BI-FOLD

## FOLDING DOOR SYSTEM

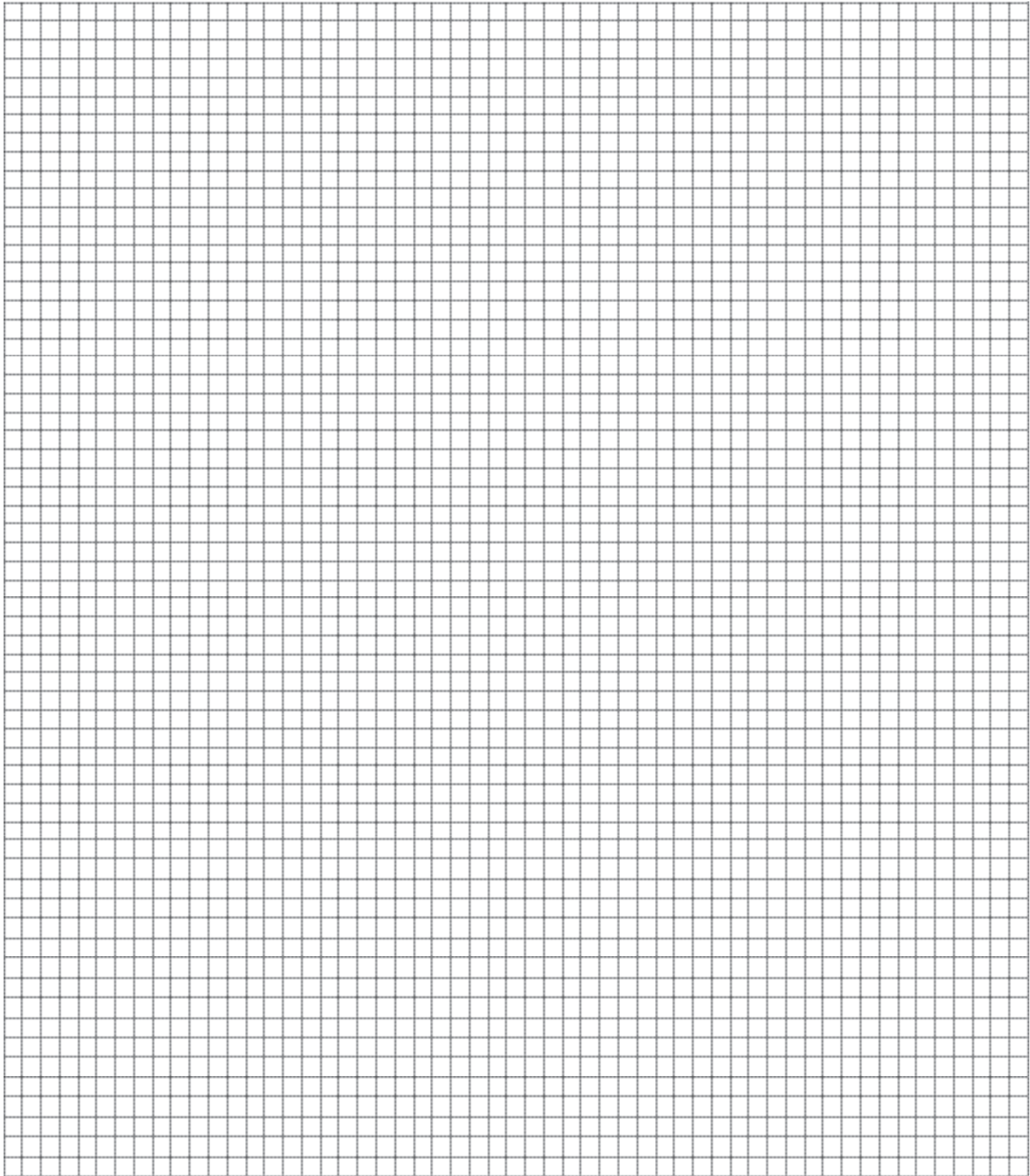

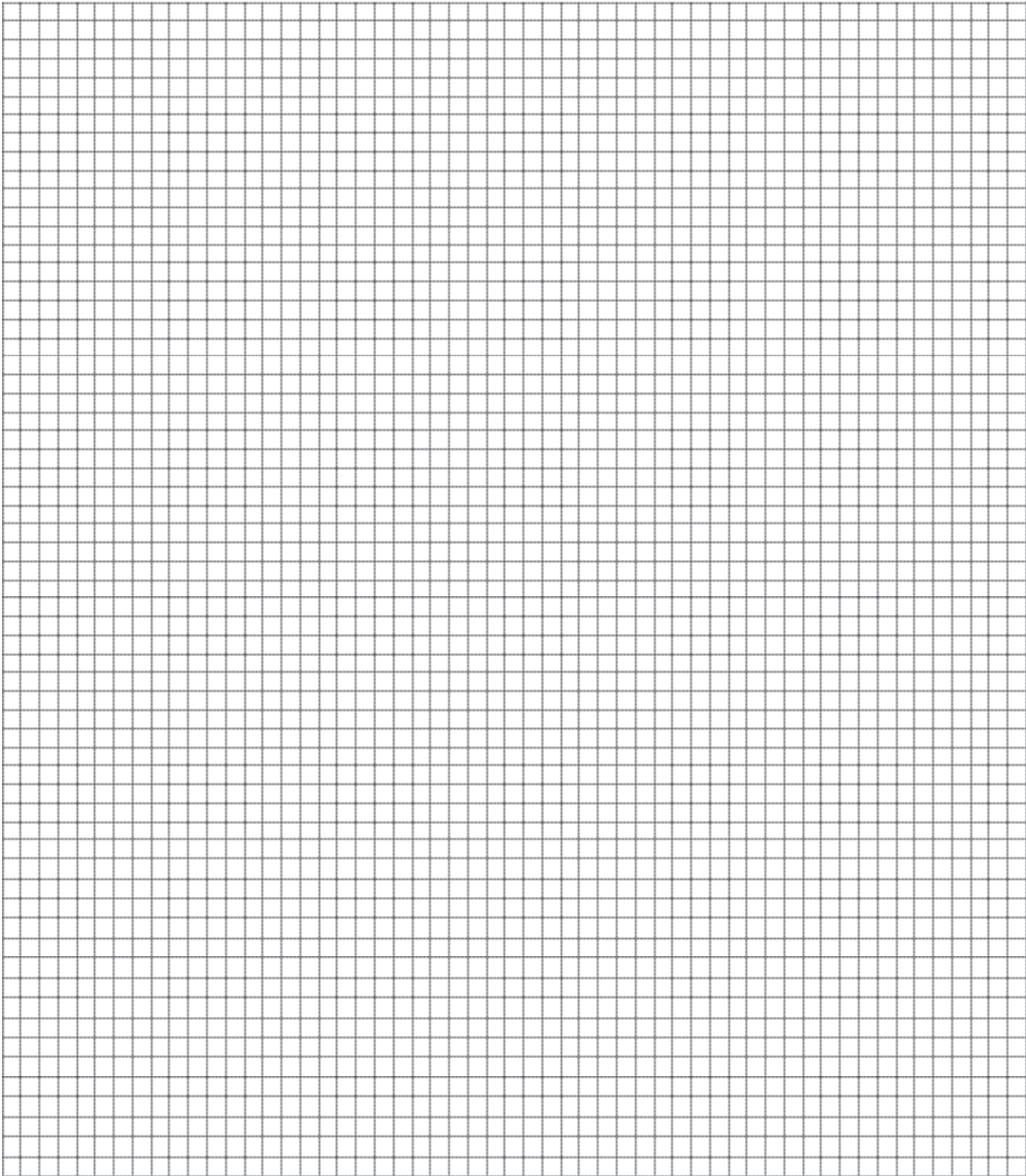

Technical specifications are subject to change. All rights reserved raumplus North America.  
Should you have any further questions, please contact your **raumplus** representative.

Published by:

**raumplus** North America • 866 580 0112

Corporate Office / USA • 866 580 0112

Sales Office / New York • 212 947 0404

Corporate Office / CANADA • 866 999 3949